



Airstream Adventures Around the Southeast

Southeastern Camping Unit

Region 3

Unit 12

Jan. 23

Inside this Issue:

Member Spotlight	2
Happy Hour Recipe	2
Treasurer Report	3
Recent Rallies	5
Future Rallies	6
Other Information	7

Editor's Notes:

- *Airstream Adventures will be published 6 times per year (or more). Publications will distribute in January, March, May, July, September, and November.*
- *Due dates for all articles and pictures will be the 15th of the month preceding publication.*

Editor in Chief:

Cory Barger
SECU Secretary

PRESIDENT'S PIECE OF MIND

Thoughts From Inside The Airstream

Happy New Year to all of our members and affiliates, both new and old! Hopefully everyone had a safe and wonderful holiday season and stayed warm! **A huge warm welcome to all our new members and affiliates. We all look forward to seeing you at a rally down the road.**

Canopener was fabulous and it was great to see so many SECU members and affiliates there. Just take a look at the multiple group photos and you can tell that everyone had a blast.

Now that the shortest day of last year is behind us it is time to start looking forward and planning our spring, summer, and fall rallies. As previously mentioned in the December 2022 newsletter we have the G.O.A.T. Rally from February 16th to the 19th. Please contact Steve Cook for more info at SteveCook@mailnew.com. The Region 3 Rally will be held in Myrtle Beach from March 29th to April 2nd. Come hang out with me at the Florence Marina State Park in Georgia from April 8th to the 10th on your way to Texas for the 2nd annual Taste of Texas Rally. Kathy Carl will be putting on a great "no fee" rally from May 3rd to the 8th at the Guadalupe River State Park. There will be plenty of planned day trips, happy hours, and pot lucks thrown in for good measure.

We appreciate Steve, Matty, and Kathy stepping up to host these wonderful and exciting rallies. If you would like to host a rally, we would be happy to put you in contact with others that can help provide support to you. You pick the spot, set up the reservation information, and the rest will fall into place.

I know there have been some questions and concerns about the upcoming 2024 increase in dues. Alan has your burning questions answered in the Treasurer report found on page 3 of this newsletter. If you have other questions after reading please feel free to reach out to us using SECUinfo012@gmail.com. We still have plenty of room for volunteers on our budget committee whose mission is to provide insight and help ensure financial stability of SECU making sure it is properly funded into the future.

We also have room for volunteers for the rally committee whose mission is to prevent stagnation of rallies. This group of volunteer will work to find varied and interesting locations for rallies that will provide unique and inclusive gatherings for all current and prospective members. If you are interested in volunteering for either of these two committees, we want to hear from you!

Because so many folks have asked, the dates have been set for the next Farm Life Rally. Make sure to pencil in February 8th to the 12th of 2024. Registration will open in the summer of 2023.

I hope to see you each and every one of you down the road this year. Drive safe and be safe but most of all have fun and take plenty of pictures to share. Life is a party to be enjoyed by all.

- Lisa Forsyth, SECU President

Your SECU Leadership Team

Lisa Forsyth — President

Matty Garrett — Vice President

Alan Rabb — Treasurer

Cory Barger — Secretary

Contact Us: SECUinfo012@gmail.com



SECU Member Spotlight



Steve Cook — Trustee



I saw my first Airstream on a camping trip to north Georgia in the early 80's. That short view of the Top of Georgia Airstream Park sparked a long time interest in this unique trailer. Many years past before I was able to dive into the Airstream life. I was able to talk Matty into buying the very first Airstream we looked at. It's been a labor of love remodeling the 'Shiny Shack' to suit our needs. Our 4 years as members of WBCCI have been some of the most interesting we have shared. Looking forward to many more adventures and rallies in the futures.

Erik Van Dyke—Trustee

I'm originally from the Netherlands, came here in my wooden shoes (not really) as a boy. Spent my childhood in Hawaii, then my dad's job moved us back to Europe, Germany this time. It was a great place to be a teenager. When it was time for college, I moved to Atlanta to go to Georgia Tech. I'd never been to Georgia, but liked the Tech fight song, so I picked that school. Eventually, I ended up in the automotive industry in various positions with several car companies and a software company before retiring.

Carol and I bought our Airstream 28' Flying Cloud (called the Baby Zeppelin) in 2018. We joined SECU and have enjoyed the camaraderie of many rallies as well as the adventures of solo trips around the southeast and one cross-country. Two years ago we got interested in caravans and have participated in five total. This most recent Christmas and New Year was our fourth Canopener rally and this coming year we have already scheduled another three caravans.

We really enjoy being members of SECU and participating in all the events opened up to us through Airstream ownership and WBCCI membership.



New Year Holiday Punch

Start your new year parties off right with this bourbon and vodka punch!

INGREDIENTS:

- 1 Pint Vodka
- 1 Pint Bourbon
- 4 Cups Cranberry Juice or Cranapple Juice
- 12 Ounces Frozen Lemonade — Undiluted
- 12 Ounces Frozen Orange Juice — Undiluted
- 2 Liters Ginger Ale
- Whole Cranberries, Oranges Slices, and Lemon Slices

INSTRUCTIONS:

1. Combine vodka, bourbon, juices, and lemonade in a punch bowl or large pitcher.
2. Add ginger ale just before serving.
3. Garnish with whole cranberries, orange slices, and lemon slices. CHEERS!



TREASURER

Happy new year to everyone. I hope that everyone had a wonderful holiday season and have remained safe.

For this month's update I wanted to update you on the dues increase for 2024 from \$1 per year to \$5 per year. As you can imagine when there is change in anything that we hold as normal or the "status quo" some people have more anxiety with that change than others do. Change can be a wonderful thing given that we have the proper context to understand the reason for the change. Let me see if I can outline this so it makes some sense and gives everyone a bit more peace of mind on the increase.

As you may be aware, SECU has enjoyed one of the lowest if not the lowest dues for a club within all of WBCCI at \$1 per year. It has been a wonderful thing, but we are at the point that \$1 for dues with a member base of APPROXIMATELY 200 airstreams does not generate very much - if any - excess cash to do anything for our members.

First let me outline for everyone the type of annual expenditures that the club has. Please keep in mind that we currently take in ABOUT \$200 a year in dues. Some of these expenditures include:

- A past president flag for our outgoing president which is approximately \$95 or approximately 48% of annual collected dues.
- SECU's annual 990N IRS filing which is \$40 or 20% of annual collected dues.
- Annual bank maintenance fees which are billed monthly. \$96 per year or 48% of annual dues. This has been waived by the bank, for now, but will officially become effective in mid 2023.
- Additional SECU banner purchase for use at future rallies which is approximately \$50 or approximately 25% of annual dues.
- Unplanned expenses during the year for items such as SECU badges, business cards, advertising, food, gifts, and the occasional SECU sponsored lunches or happy hour at rallies including International and IBT.

In the past many of the items to get the unit up and running included:

- A SECU flag and logo including designing costs.
- Volunteer members fronting **their own** money for flags, caps, stickers, shirts etc. for member purchase, all at cost. Please understand that if these items never sell then that member is out of pocket the money they fronted to purchase the items and this practice is simply **WRONG**.
- SECU led rallies generally have a host sponsor and those host volunteers front much of the cost for any rally meals, gift bags and any type of entertainment. This can cost the host volunteer in the \$100's of dollars for one event.
- The Bloody Mary Event at Canopener is where a number of members contribute various supplies for the event. Even though there is a jar for donations, all of this money is donated back to the state park for allowing the event to happen. The cost for this event is contributed by SECU members who step up and volunteer to donate.

Members volunteering their time and resources (both financial and non-financial) has been a wonderful reason to be a part of SECU. What I have personally witnessed in the last 4 years in the club is that it is always the same 15 to 20 people that do all the work. These individuals are often paying out of pocket for expenses and are not being reimbursed by the SECU treasury for their costs. This practice is a bad habit that is **WRONG** for the club and its members who volunteer. Up to this point, we have been able to get by on the \$1 annual dues, but in the future these volunteers need to be reimbursed for their costs. The ability to reimburse members for the costs they put out may actually drive others to step-up to volunteer. We also need to move the club forward with other activities and events. Although we have relied heavily on volunteers, various donations, and financial investments in the past, it is not guaranteed that that will continue into the future.

(continued on the next page)

TREASURER

(continued from previous page)

Just a few of the ideas for what the increase in dues will be used for going forward:

- SECU ‘special’ badges. These cost about \$1.50-\$2.00 and going forward those will be free as the cost will be absorbed by the treasury.
- Hard goods that have been purchased by volunteers members in the past and sold to SECU members at their cost. These type of items included hats, stickers, shirts, flags, etc. These items will be purchased from the volunteers and inventoried by the board. We will then continue to make those few items available for purchase through a future ‘yard sale’. Any inventory that does not get purchased by our members will have to be absorbed by the treasury, this is simply the right thing to do. Going forward, we are working on partnering with a retail company that can provide caps, shirts, and other merchandise with the SECU logo that members will be able to purchase at their leisure. Doing this will not require us to maintain an inventory or have a specific amount of individuals interested in the product before we can place an order.
- There is a rally that is being held in February that is a boondocking rally, the G.O.A.T. Rally. There is an option to collect a rally fee to cover the cost of the porta potty or have the treasury assume that cost. These are the types of decisions that will be decided by the budget subcommittee that Lisa mentioned in her ‘Piece of Mind’.
- Future SECU sponsored rallies where an occasional meal/entertainment would be provided. In the past, all expenses for this type of option was assumed by the rally host with no financial compensation.
- A fund for rally hosts to access for gift bags, door prizes, or welcome gifts that can be given away at the start of a rally.
- The occasional lunch, pizza party, or appetizers for a cocktail party at scaled events like IBT or International.

These are all ROUGH ideas that we can now begin to think about with the implementation of the modest \$4 increase in fees.

I will close by saying that I know there have been some people that have had an issue with the \$4 increase. I do understand that. But please understand that your board is trying to progressively move this unit forward. The things we would like to implement for the future will not cost a fortune, which is why the board implemented the change for 2024. The roughly \$800 additional in the SECU bank account is significant to SECU. If the impact of the \$4 is an issue for anyone then please reach out to me privately and I will be happy to cover the increase for the first year for anyone who requests it. I am passionate about this club moving and growing into the future. Please remember everything that is done within SECU is done by **VOLUNTEERS**. Remember to please be kind to one another and lets all treat each other with some respect when we are voicing differing opinions. Personally, I have been insulted because of this change on a few occasions. We should all strive to do better.

- Alan Rabb, SECU Treasurer

012membershipchair@wbcci.net



Year	Regular Members	Affiliate Members	Total Members
Summer '22	115	62	177
December '22	118	101	219
January '23	121	119	240
Paid to Date	102	110	212

Great news for SECU! Our membership is on the rise!!

CANOPENING & CANOPENER RALLY

WOW! What an amazing rally!

The Canopening Pre-Rally kicked off an amazing Canopener Rally where lots of SECU members and affiliates engaged in fun & sun!

The New Year was kicked off with a Polar Plunge in the pool.

Many enjoyed the great entertainment at Kith & Kin Coffee.

A ton of attendees packed 30A Axe to test their axe throwing skills. As it says on their front window,

“Alcohol & Axes—What could go wrong?”

The Mardi Paws Parade was a huge hit for the four-legged attendees and their two-legged companions.

Parlor Doughnuts showed up in their amazing Airstream to sell coffee and donuts.

The famous Canopener Corn Hole Tournament and Chili Feed were a huge hit and it was apparent why this was the main event!

The end of the week saw a PJ day where attendees could swing by and pick up their Bloody Mary, enjoy some camaraderie, and even win a few door prizes.

All in all, a great rally with plenty of fun had by all.



G.O.A.T Rally

February 16th

to

February 19th

Hosted by Steve Cook &
Matty Garrett

Cost: \$25 / Limited to 12 Airstreams

For more information or to register
email Steve Cook at
SteveCook@mailnew.com.

What does **G.O.A.T.** stand for?

Well most people think it's the Greatest Of All Time. But, what it really stands for is ***Get Out And Travel*** or ***Gathering Our Airstreams Together!***

Join your SECU Hosts Steve Cook and Matty Garrett for a boondocking rally at a goat farm. Serenity Acres is also a Harvest Host so you may have visited them in the past or even have future plans to stay there. This is a great location for a small rally in their 2 acre pasture. Port-A-Potty will be onsite to be mindful of black tanks.

There will be plenty of baby goats begging to be held, petted, or played with.

Located near the Withlacoochee and Suwanee Rivers, if the weather cooperates, an outing with the help of a local outfitter may be possible.

Valdosta is mere minutes away and is home to several, very tasty, locally owned restaurants and the Georgia Beer Company.

Hanging Out By the Water

Impromptu Rally

April 6th to April 10th

Florence Marina State Park

Just an informal gathering over Easter weekend, where there is plenty to do and plenty to not do. Boat rentals, hiking, museums, and White Oak Pastures.

Whether you are making your way to the Taste of Texas Rally or would just like to spend the weekend with a few SECU friends, there is plenty of room for all.

Interested individuals should make their own reservations with Florence Marina State Park.

Depending on the number of interested members and affiliates, some group activities may be able to be scheduled ahead of time.

For questions or more information please email Lisa Forsyth at LJForsyth2000@gmail.com.

2nd Annual Taste of Texas Rally

May 3rd to May 8th

Guadalupe State Park

SECU will be hosting it's 2nd Annual Taste of Texas Rally at the Guadalupe State Park. Reservations for sites in the Turkey Sink Loop can be made for \$24 per night plus \$8 per person per day. Site numbers for the rally are 38 thru 85. Sites are 50 amp service with water but no sewer. Fishing, kayaking, and swimming are all available.

Day trips to San Antonio, New Braunfels, Driftwood, and Dripping Springs are just a short drive away. You can visit the Alamo, partake in delicious German food, and even visit a few distilleries nearby to sample their wares.

This is a 'no fee' rally meaning you are responsible for making your reservations and all meals. Carpooling will be offered for day trips. For more information or to be added to the list contact Kathy Carl by phone at 830-708-2235 or email at Kathy@KathyCarl.com

The SECU Merchandise Store

Your SECU Leadership Team are working hard to create a virtual store to sell currently available merchandise. This virtual “yard sale” will happen in an attempt to vacate any previously purchased merchandise to empty the coffers for our next BIG THING! We are working with several retailers to create a just in time ordering process so there will not be a need to maintain an inventory that a volunteer would have to travel with. Several other clubs have moved to this type of system and their members love it because they are able to order at their leisure and able to pick the items and colors they want for themselves. All currently available items in the virtual store will be sold to you at cost plus shipping. The members that currently hold some of this inventory can often be found at rallies and can often sell you what they have left if they are traveling with their items. Be on the lookout for more information on the Facebook page and the March Newsletter regarding the centralization and virtualization of the items available from the SECU merchandise store.

- Roy Beavers has 8 flags for sale. His email is 012info@wbcci.net. The cost is \$42 and \$50 if you want it shipped.
- Alan Rabb has 5 SECU decals available. The cost is \$2. His email is 012membershipchair@wbcci.net.
- Matt Hackney has 2 hats for sale at a cost of \$22. He also has lots of decals at a cost of \$2 and 1 SECU flag at a cost of \$42 or \$50 with shipping. His email is eronry@aol.com.
- <https://www.buildasign.com> has the SECU decal and can make a cardboard yard sign if you contact them for design and cost.
- SECU ‘special badges’ are awaiting approval from IBT and will be available soon. Please stay tuned for timing on how to get yours for free. That’s right the cost will be **\$0**.



What’s coming in the next edition?

More member profiles, recipes, thoughts from our president, information regarding our merchandise store, and so much more!

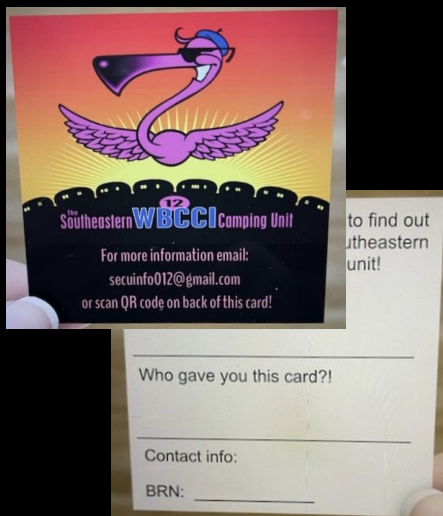

INFORMATION CARDS COMING SOON!

Did you ever meet someone and talk their ear off about all the great things offered by Southeastern Camping Unit and then wanted to direct them to get more information about the club but didn't have a pen and paper?

NOW YOU CAN!

Coming soon we will have business cards that members and affiliates can pass out to potential new members that includes a QR Code to direct them to the SECU page of the ACI Website.

