



Region 4 WBCCI



February 2010	http://Region4.wbcci.net	Volume 1 Issue 4
---------------	---	------------------

Region 4 Officers

- President** John Turner
jrturmer@prodigy.net
 586-739-0225
- 1st V President** Karin Kurkowski
klkurkowski@wmconnect.com
 248-649-5355
- 2nd V President** Marjorie Lotz
mlotz@ymail.com
 248-649-5355
- Treasurer** Maurice Runyan
Runyanmi3161@yahoo.com
 810-245-0914



Region 4 Chairmen

- Caravan** Norm Hewer
Nmh133@aol.com
 586-781-9419
- Parliamentarian** Glenn Patsch
 330-721-9817
- Photographer** Bill Grawe
wgrawesr@hotmail.com
 513-825-3057
- Webmaster & Newsletter** Dave Brett
dbrett@ampteks.net
 330-757-8751
- Youth** Sonny & Mary Lou Thompson
wbcci26632@sbcglobal.net
 937-879-9743

President's Corner

Hello everyone.

The IBT is history and there were a few votes that affect us all. I'm not going to have a comment on all of the results, but I will have a comment on issues I feel everyone will be interested in. If any one has a specific question e-mail it to me and I will answer it to the best of my ability. We had 29 motions to consider and not a lot of time to spend on each issue, but there were some exceptions.

- (1) Unit name change passed
- (2) The transfer of funds was misunderstood by quite a few members. This was a yes vote so the WBCCI could get their money back from the International Rally Fund.
- (3) No! The unit and Region that puts on the rally should get any money that is above and beyond the expense.
- (4) Yes! The more info we get the better.

(5) Referred back to maker. (6) Yes (7) Yes! We needed this so we could implement a change that was passed in June. (8) Yes! (9) Yes! (10) Yes! Region 4 does not get paid mileage to attend their own rallies now. This puts all regions on a level playing field. (11) Yes! Corrects previous error (12) Yes! This reduces International travel funds by 25% or approximately \$10M. I would like to add that the International Officers are a long way from spending all of their budget this year. (13) Yes! Reduces region officer's travel by 10%. Would have been more but we are not sure what is going to be needed if we combine regions in the future. (14) Yes! Increase International dues from \$55 to \$65 a request for \$75 was amended to \$65. I did not want to increase dues but there was no way to balance the budget with out it. If we eliminate all International and Region travel budgets we would still have a deficit by 2012. By the June meeting I'm sure we will have ways to cut more. The 2020 committee is working on motion 26 now. I will keep you posted on this one. If you have any suggestions e-mail me. (PS) I do not do the forums so post what you want, but I will never see it. (15) No! Would have changed the way units tallied votes. (16) Withdrawn (17) Yes! We need marketing to go forward with some plans to get new members and more ads for the Blue Beret. (18) Yes! This motion combined all of the grievance motions into one. We have had 58 grievances this year. Come on enough is enough lets get back to Fun and Adventure.(26) Yes! This was passed on to the 2020 committee. If some or all of this passes it would save up to \$80M a year. It would combine regions, combine Region and International rallies; eliminate some international officers and more. We are going to down size. I hope all the members of Region 4 will give me feed back on what you like and dislike about any new issues that come up. I sent out an e-mail asking the members what they thought about the \$20 increase in dues and received responses from 4 units. It's our club let's get involved and let me know what your thoughts are. Motion (27) (28) (29) were withdrawn. It must be Happy Hour some where.

We will talk more about this at the Region 4 business Rally in Wauseon. It will be open to all members. Hope to see you then.

**Safe travels
John**

Motions Presented at IBT

The motions considered at IBT are very lengthy – those interested in reading the motions can find them at http://watchungunit.org/2010_IBT_Motions.pdf . President Turner also has the minutes of the IBT available to those interested, please contact John at jrturner@prodigy.net .

Region Rally Updates

President John Turner sent these comments to help you with planning for the Region Rally in Wauseon.

It sounds like no matter where you go to keep warm in the winter we all got a little bit of the white stuff this year. Some of us more than others.

We are getting ready for the rally in Wauseon, there is more to putting a rally on than I first thought it would be, but we are getting there slow but sure. We will be discussing some important subjects that involve all of us so I hope you all make it.

I have been asked to pass on to the members that there will be a Vintage Parking Area for any members that want it, and that they are planning on having an open house either Friday or Sat. morning.

Parking for the Region Rally starts May 17 at noon. For those wishing to arrive early there will be early parking available at \$15.00/night.

From the WBCCI Forums

The Forum Folks continue to add new feature to the forums and announced two more updates this month.

[1] A brand-new complete overhaul of the portal page/homepage. The new portal page will streamline and simplify the message, purpose, and intent of the Club Forum. And it will put a professional face on the forum that is worthy of this prestigious Club.

[2] Professional Forum Newsletters that will be sent electronically via email to all forum members. The newsletter will include pertinent forum news, club news, new members, items of interest, etc. This may also be a testing ground for electronic media possibilities for the entire club at-large.

The Forum is also looking for your input on what you would like to see in the Forum Newsletter. Check out the changes while you are registering on the Forum today.

The screenshot displays the WBCCI Airstream Forum website. At the top, the header includes the site logo, navigation links (Home, Forums, Gallery, Links, Register, User CP, Profiles, Search, Fwd), and a sponsor notice for vintage-airstream.com. Below the header is a navigation menu with links for Home, Forums, Gallery, Links, Register, User CP, Profiles, Search, and Fwd.

The main content area features a large banner for "WBCCI Airstream Forums The Original Airstream Community" with a scenic image of a bridge over water. To the right of the banner is a login form with fields for "User Name" and "Password", a "Remember Me?" checkbox, and a "Log in" button.

Below the banner is a "Become a Member" section with the text "Registration only take a minute and it's absolutely FREE!" and a "JOIN NOW" button. To the left of this section is a "Recent Photos" gallery with a "Browse All Photos" link, displaying a grid of 15 small images of various airstreams.

To the right of the "Become a Member" section is a "Recent Threads" table with columns for "POST TITLE", "REPLIES", and "VIEWS". The table lists several threads with their respective reply and view counts.

At the bottom of the page, there is a footer with the text "All times are GMT -5. The time now is 01:10pm" and "Contents © 2010 WBCCI™ All Rights Reserved".

2010 Community Service

Janet Kendig passed along this note on new organizations we will be working with at the International:

I have a few new organizations we would like to help this year while in Gillette. The first is a women's abuse shelter. Their request is for travel size items such as: soap, shampoo, deodorant, combs etc. We are hoping to make up a few packets with these items to be given to the shelter. The second is for a house for kids in crisis. They need socks (for up to 10 yrs. of age) and PJ's in small sizes. When these children are taken into this shelter they come with nothing and I hope we can help in some small way. The third is Yarn. If anyone has yarn they are not going to use, bring it to Gillette. If you see any that you would like to take from the box, you may. What is left will be donated to churches or any organization that can use it. We will have the blood mobile on site on the 30th Jun and 1st July. You are asked to bring a picture ID when you donate. Children's "gently" used books will again be collected. If your children or grand-children have moved on to more mature reading please consider contributing the books for organizations in Gillette. We will still be collecting Stuffed animals, knit hats, blankets & scarves, cents for kids, food, old towels & Clorox for the animal shelter and of course food for the food pantry. If everyone could help with just one or two of these items it would be greatly appreciated by the people of Gillette.

Thanks for all your support.
Janet Kendig, Community Service.



If You Build It . . .

Region 4 Airstreamers Rick & Elaine Richardson have suggested Region 4 become involved in a Habitat for Humanity build.

Habitat is scheduling building projects known as Care-A-Vans specifically for RVers. Here are a few particulars:

Most RV Care-A-Vanner builds involve eight to 20 volunteers and last two weeks, with 10 six- to seven-hour workdays. A typical day begins with devotions and includes morning, lunch and afternoon breaks. Volunteers bring their own hand tools—tool belt, hammer, square, pencil, measuring tape—and the affiliate provides everything else including power tools, ladders, building materials, instruction and supervision.

Care-A-Vanners are on teams. Team members pay their own expenses, which may be tax deductible, and the host affiliate arranges for RV parking—usually free or at a nominal charge. Teams can expect at least minimal electric hookups, access to water and a dump station nearby. Hosting affiliates also may provide lunches and a welcome gathering. Due to safety and hygiene issues, pets are not permitted on the work site.

There is a build scheduled for June 13 – 25 in Sheridan Wyoming that is filling up fast. Sheridan is less than 100 miles from the International in Gillette that starts on June 27th – here is a chance to add two weeks to your International visit to Wyoming and get free parking! Rick & Elaine would like to hear from all members with an interest in participating in a Care-A-Van. Please email them at rickelainehq@gmail.com.

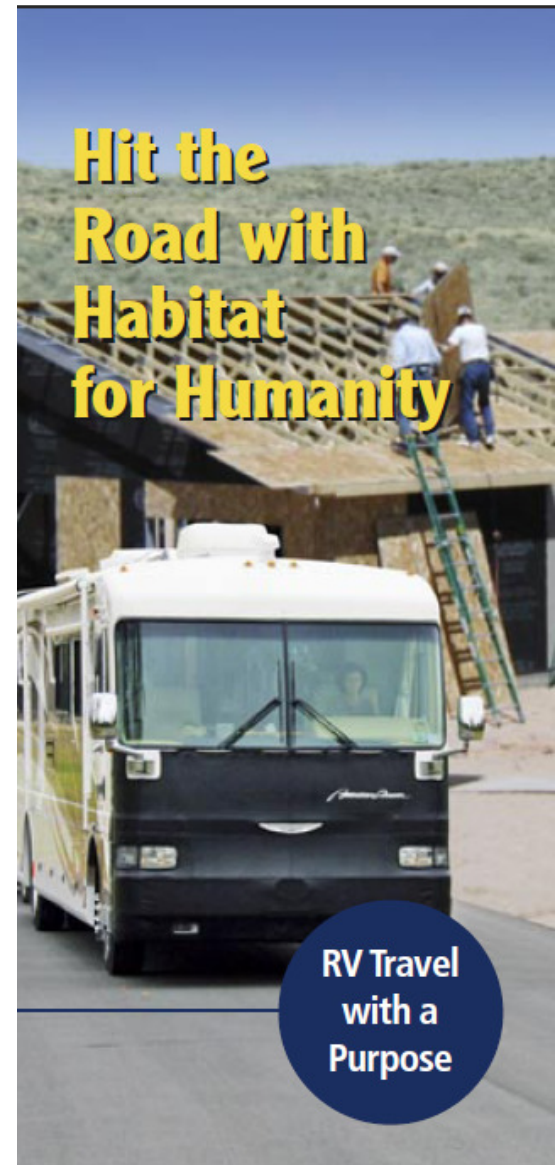



Alumapalooza

Airstream Life magazine is sponsoring a rally at Jackson Center June 1-6, 2010. Region 4 has been asked to set up the WBCCI booth at the rally and will be handing out WBCCI literature and talking with folks. Region 2nd Vice President Marjorie Lotz is looking for members to help man the booth – if you can help please contact Marjorie: mloetz@ymail.com.

Alumapalooza features a packed schedule of entertainment, learning, and interaction.

Over 15 talks, seminars, and demonstrations will be presented by Airstream staff, Airstream dealers, Airstream Life magazine contributors, and vendors. Door prizes at Happy Hour every day, movies or live entertainment every night — plus live bands performing in downtown Jackson Center on three nights!

Take your pick of 3, 4, or 5 days on-site, to suit your schedule. Service and parts will be available during the event by prior arrangement. By special arrangement, factory tours will be run twice daily Tuesday through Friday.

Every day there will be seminars, door prizes, entertainment, and camaraderie, so come early to avoid missing anything! If you can't come until the weekend, don't worry because you will still catch the Swap Meet, Open House, trick roper [Chris McDaniel](#) on Friday night, magician [Joe Diamond](#) on stage Saturday, the barbecue party, the biggest door prizes of the week, a classic car show, and evening music.

Kids under 15 free • Vegetarian meal option • Generator section • Good dogs welcome • Meet the Airstream staff • Discounts available on JC Days

For more information or to register go to <http://airstreamlife.com/alumapalooza>. (Graphic and rally details courtesy of Airstream Life Magazine)

Did You Know . . .

Wauseon is the home of the Fulton County Historical Museum?

The museum has undertaken a 5 year project titled "Hell & Homefront: Civil War Through Fulton County Eyes"



The museum has an extensive collection of Civil War artifacts, but will not focus on a glorification of war or battles. They instead intend to collect information on the viewpoints of Fulton County residents both on the battlefield and at the home front. Their findings will be reported in a series of presentations this spring at the three area libraries. More information is available at www.fultoncountyhs.org

Wauseon was named after a Potawatomi chief. The Potawatomi were part of the Algonquian Family located in the upper Mississippi region.

The Sauder Woodworking Company in nearby Archbold operates a co-gen plant that burns sawdust to create electricity. The plant burns as much as 145 tons of sawdust daily. In addition to Sauder there are also other furniture manufacturers such as Archbold Furniture Company that specializes in unfinished furniture made of real wood.



2010 In Gillette

- You can expect to play BongoBall at the International Rally at Gillette.
- The Post Office will be located at the Spirit Hall Vestibule.
- Band Practice will be June 25th at 8:00am
- Hitch up/Back up clinic for women will be June 29th at 8:30am
- Where can you find more vital information about the International Rally?

<http://www.wbcci.org>

Follow the link for Intl Rally at the top of the page to find:

- ✓ A Pre-Rally booklet that includes a layout of the rally grounds and descriptions of the scheduled tours and activities.
- ✓ A Rally Program. Preliminary schedule of events for the rally.
- ✓ The Rally Registration Form
- ✓ First Timer Hints. What to expect, what to do, what to wear, etc.



53rd International Rally

Gillette, Wyoming
June 27 - July 4, 2010

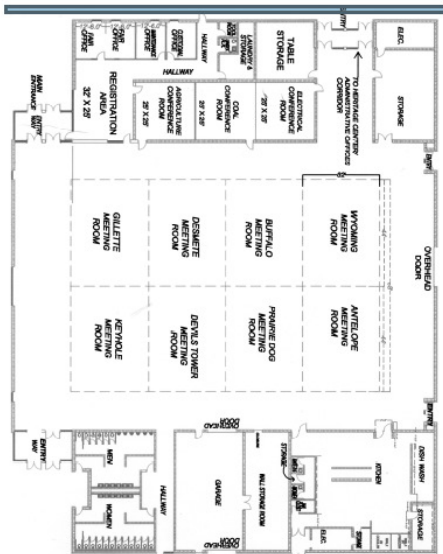

Energy Hall

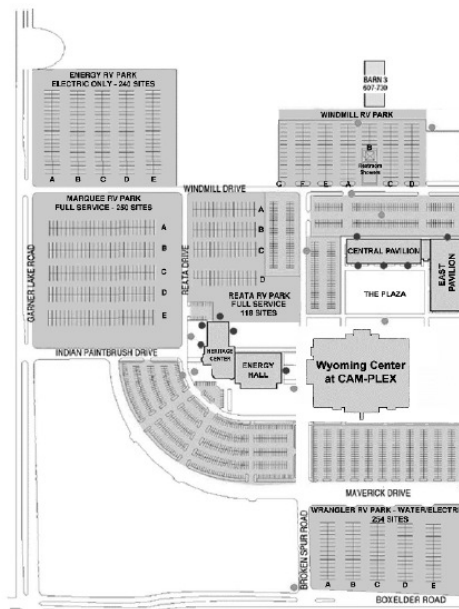

Cam-Plex Ev

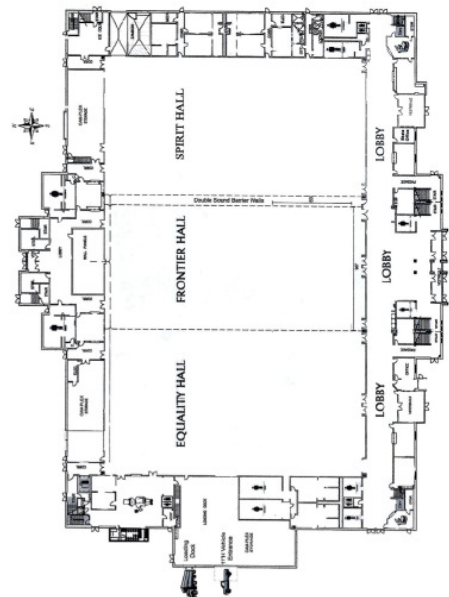

Wyoming Center



Springtime in Wauseon 34th Annual Region 4 Rally May 18th-23rd, 2010 Wauseon, Ohio

Games
Hospitality
Hobby Show
Golf

Entertainment
Line Dancing
Dinners
Ice Cream

Water & Electric
Popcorn
Flea Market
Seminars

Tours
Games
Dump Site
Sunday Worship

For info call John and Karen 1-586-739-0225 email JRTURNER@prodigy.net
Or Karin and Larry 1-586-210-1777 email klkurkowski@wmconnect.com

Make Checks Payable To Region 4 WBCCI: Mail with bottom portion to
Maury Runyan
1469 Trackwood Dr.
Lapeer, MI 48446

Name: _____ **Spouse:** _____

Address: _____ **City:** _____ **State:** _____

Zip Code: _____ **Phone:** _____ **E-Mail** _____

Membership # _____ **Unit:** _____ **Unit #** _____

Handicapped Parking _____ **Total # in Party** _____

Rally Fee

2 Persons \$175.00 **After 4/1/2010** \$185.00 _____

1 Person \$135.00 _____

Extra Adult \$35.00 _____

Total _____

(Early parking is available for \$15.00/day)





**WALLY BYAM CARAVAN CLUB
INTERNATIONAL, INC.
53RD INTERNATIONAL CONVENTION/RALLY
JUNE 27 - JULY 4, 2010 • GILLETTE, WYOMING
REGISTRATION**

Convention/Rally Fees for registrations received prior to **January 1, 2010**, will be **\$480** for couples, **\$380** for singles, and **\$120** for each additional adult. **Convention/Rally fees for the first 1000 to register include 30 amp electricity, water, and sewer (No 3 amp electricity or generator section available).**

Rally Fees received after **January 1, 2010**, will be **\$500.00** for couples, **\$390** for singles, and **\$130** for additional adults.

Through the courtesy of Airstream, Inc., all members pre-registering on or before January 1, 2010, will be eligible to participate in a drawing for up to a total of **\$2,000.00** in awards. The award may be redeemed at *any Airstream Dealership* or at the *Jackson Center Service Facility* for parts and service.

Free parking in the Bull Pen, with no services, is permitted only for the one night before your parking date. Additional nights in Bull Pen parking prior to your parking date will be at the rate of \$20.00/night, **with no hook-ups.**

FEE REFUND POLICY All convention/rally fee refund requests must be postmarked by **May 15, 2010**, and **must** include the complete pass receipt. All cancellations will be assessed a \$30.00 administrative fee. There will be no refunds if postmarked after May 15 except as approved by the International Rally Committee.

Convention/Rally Parking Pass Receipts will be mailed beginning January 15, 2010.

Make checks payable to: **WBCCI**
Mail to: **WBCCI, P.O. Box 612, Jackson Center, OH 45334**
Canadian Checks must be stamped "US Funds"

For registrars only:
Amt: _____ Check # _____
Date: _____ Recd. by: _____

**53rd International Convention/Rally
Gillette, Wyoming
June 27 - July 4, 2010**

LAST NAME _____ FIRST _____ WBCCI # _____

SPOUSE _____

ADDRESS _____

CITY _____ ST/PROV _____ ZIP _____

RALLY FEES INCLUDE FULL HOOK-UPS (30 AMP ELECT, WATER, SEWER)

<u>Number</u>	<u>Fees</u>	<u>Fees</u>	<u>Amount</u>
	prior to Jan. 1	after Jan. 1	
<input type="checkbox"/> Airstream w/2 adults	@ \$480.00	@ \$500.00	_____
<input type="checkbox"/> Airstream w/1 adult	@ \$380.00	@ \$390.00	_____
<input type="checkbox"/> Additional adult in Airstream	@ \$120.00	@ \$130.00	_____
<input type="checkbox"/> Youth (Ages 4 - 19)	@ \$ 60.00	@ \$ 60.00	_____
<input type="checkbox"/> Youth after two full youth pmts:			
_____ Youth (Ages 4 - 19)	@ FREE	@ FREE	_____
<input type="checkbox"/> Not bringing Airstream	DEDUCT \$200.00	DEDUCT \$200.00	_____
<input type="checkbox"/> WBCCI Life Members	DEDUCT \$5.00	DEDUCT \$5.00	_____

Mark boxes that apply:

First International

Staying Off Site

Bringing a Dog

Vintage Parking

Handicap Parking
Application on file at Headquarters

TOTAL FEES INCLUDED \$ _____

FEE REFUND POLICY All rally fee refund requests must be postmarked by **May 15, 2010**, and **must** include the complete pass receipt. All cancellations will be assessed a \$30.00 administrative fee. There will be no refunds if postmarked after May 15 except as approved by the International Rally Committee.

For registrars only:
Amt: _____ Check # _____
Date: _____ Recd. by: _____

Make checks payable to: **WBCCI**

Canadian checks must be stamped **US FUNDS**

Gourmet Insurance

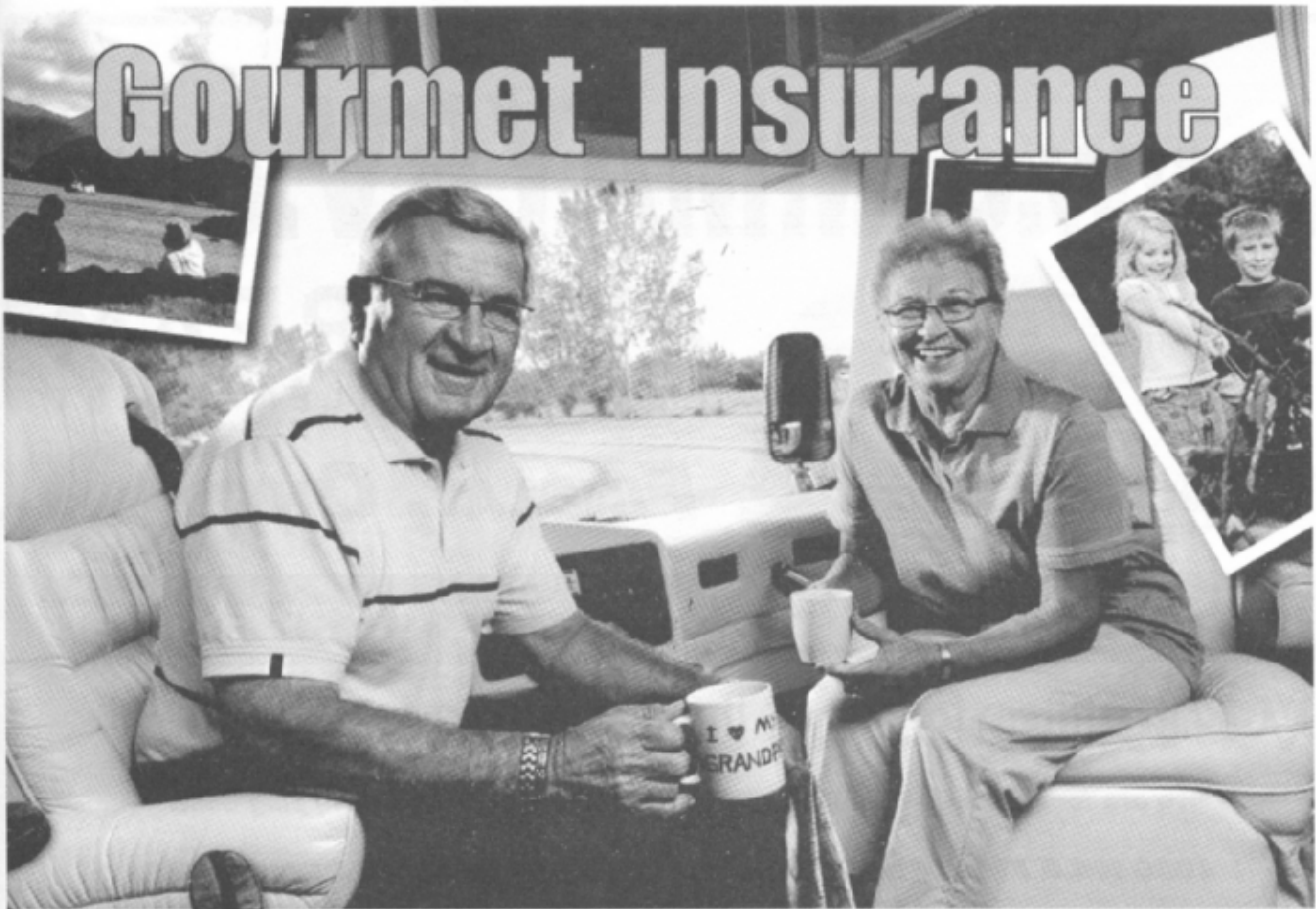

Just like good coffee, when it comes to insurance, gourmet is so much better than anything you can get “off-the-shelf”.

Check out the full-line of gourmet coverages available from **RV Advantage[®]**: Replacement Cost Guarantee, Agreed Value, Full-Timer Coverage, Diminishing Deductibles.

Call us today for your **FREE**, no-obligation quote for your RV, Auto, Umbrella, Homeowner’s, Term-Life, and Long Term Care at **800.331.1520** or visit us online at **www.rvadvantage.com**.

Free gourmet coffee sample with any quote.

RV Advantage
rvadvantage.com

FCIS ★★ ★
Farm & City
Insurance Services

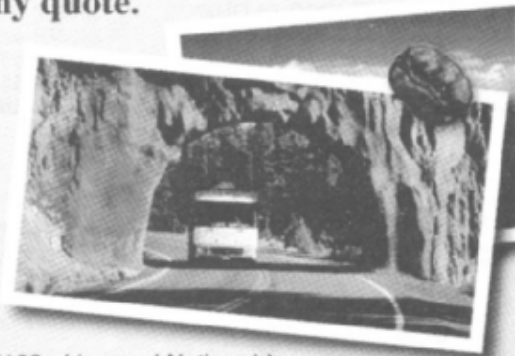

P.O. Box 248 • Forest City, IA 50436 • Fax: 641-585-5166 • Licensed Nationwide
Coverages may vary in accordance with state laws.

2009 WBCCI Corporate Sponsor



SkyMed Survivor



WBCCI Members
when calling
please reference
#1989
for special rates

"While traveling home to Michigan from Perry, Georgia my husband became very ill. We made a stop at the local emergency room in Sidney, Ohio, where he was admitted with an infected gall bladder and emergency surgery was immediately performed.

Continued Lucille, "I made a call to SkyMed advising them that I may need assistance to bring Norm home. Once Norm was able to be transported, arrangements were made to transport to our home hospital and doctor.

"Norm was taken to the airport by ambulance and put on a medical plane and flown home. His care and overall treatment went beyond our expectations. There was also an RV to be returned, and both our vehicle and RV arrived home in good condition."

"Words cannot express the praise we have for SkyMed. They were there when we needed them, and they were caring individuals who gave total concern and confidence in a time of need.

NO CO-PAYS | NO DEDUCTIBLES | NO CLAIM FORMS

Call 1-800-475-9633 or go online www.skymed.com
The Premier Emergency Air-Transportation Membership Service



2009 WBCCI Corporate Sponsor